



FOR IMMEDIATE RELEASE

December 4, 2025

MEDIA CONTACT: Rocky Merz, rocky.merz@cincinnati-oh.gov or 513.368.1620

New Sawyer Point Playground Conceptual Sketches Revealed Help Shape the Design

CINCINNATI, OH — Cincinnati Parks is excited to unveil the first conceptual sketches for the new playground at Sawyer Point, which will replace the beloved 1,000 Hands Playground tragically lost to fire last year. This project represents a once-in-a-generation opportunity to create a uniquely iconic play space that is imaginative, inclusive, and deeply rooted in Cincinnati's identity. The new playground is being designed with partner [Midstates Recreation](#), the exclusive regional provider of [Earthscape](#), known for crafting inspiring natural playgrounds that encourage creative play and meaningful social interaction.

What You Told Us

Alignment with what the community wants for this signature playground is critically important to creating something truly special for the entire region. Earlier this year, Parks asked the public for feedback about what they loved about Sawyer Point and their ideas for how to design the new playground. Almost 500 responses were received from individuals all over the area. This feedback was used to help create these initial sketches. The full summary of the feedback received may be found [here](#). Key themes included:

- **Connection to the Riverfront:** The riverwalk, water access, and scenic views were frequently mentioned.
- **Park Activities:** Events, music, school field trips, pickleball, fireworks, and volleyball were highlighted as favorite Sawyer Point experiences.
- **Safety & Comfort:** Shade, fencing, and weather protection were valued features.
- **Playground Themes:** Riverboats, nature & local animals, Cincinnati's industrial history (flying pigs and soap), and castles (a nod to the original playground) topped the list.
- **Desired Features:** Swings, slides, climbing structures, shaded areas, and water play elements were favorites.
- **Accessibility and Inclusion:** The community feedback emphasized accessibility and inclusion, which are priorities Cincinnati Parks shares for this project. The new playground will feature a variety of unique and engaging, inclusive, and accessible elements. Additionally, Parks is working with a landscape architect firm to design accessible routes

to and from the playground and explore to ways to improve accessibility throughout the surrounding park.

Help Us Build Something Extraordinary

With the design process now underway, Cincinnati Parks is again asking for public input to ensure the new playground reflects the community's vision. These initial sketches are not what the completed playground will ultimately become. These concepts represent explorations of the playground's flagship piece. In future iterations, more complimentary elements will be added to fill out the playground experience. Public feedback will be used to help shape the final design.

The public is encouraged to share their thoughts on the themes, features, and elements that will make this playground a lasting source of Cincinnati pride. Feedback may be submitted using [this brief survey](#) by December 14, 2025.

"We have a generational opportunity, and we for sure want to get it right. We are looking to build something that kids will love playing on, and is a cherished, marquee asset that is genuinely Cincinnati. The feedback we received so far was super helpful to us and that is why we're asking for your help once again." Said Jason Barron, Parks Director.

Cost and Fundraising

The estimated cost of the new playground is \$2.1 million, with funding to come from both public and private sources. Cincinnati Parks Foundation, the official philanthropic partner of Cincinnati Parks, is leading fundraising efforts. Anyone interested in contributing to help build the playground are encouraged to learn more about their fundraising efforts [here](#).

Timeline

The playground is tentatively planned to open in spring of 2027. The goal is to have the project design complete in early 2026. Fabrication of the custom equipment is expected to take 6-8 months followed by construction and installation. This schedule is dependent on fundraising as work to build and install the playground cannot commence until all the funding is received.

About the Destroyed Playground

Sawyer Point Park is one of the most heavily trafficked parks in Cincinnati, playing host to many signature events every year such as Oktoberfest, the Black Family Reunion, and the Pride Festival, among others. Constructed in 2003, the 1,000 Hands Playground was the premier playground for one of Cincinnati's premier parks. The playground featured a river theme with distinctive slides, tunnels, paddlewheel and tall stacks, as well as a rock-climbing wall, mazes, swings, and a small finger park inviting children to bring their own toys to the miniature town of "Playville."

###

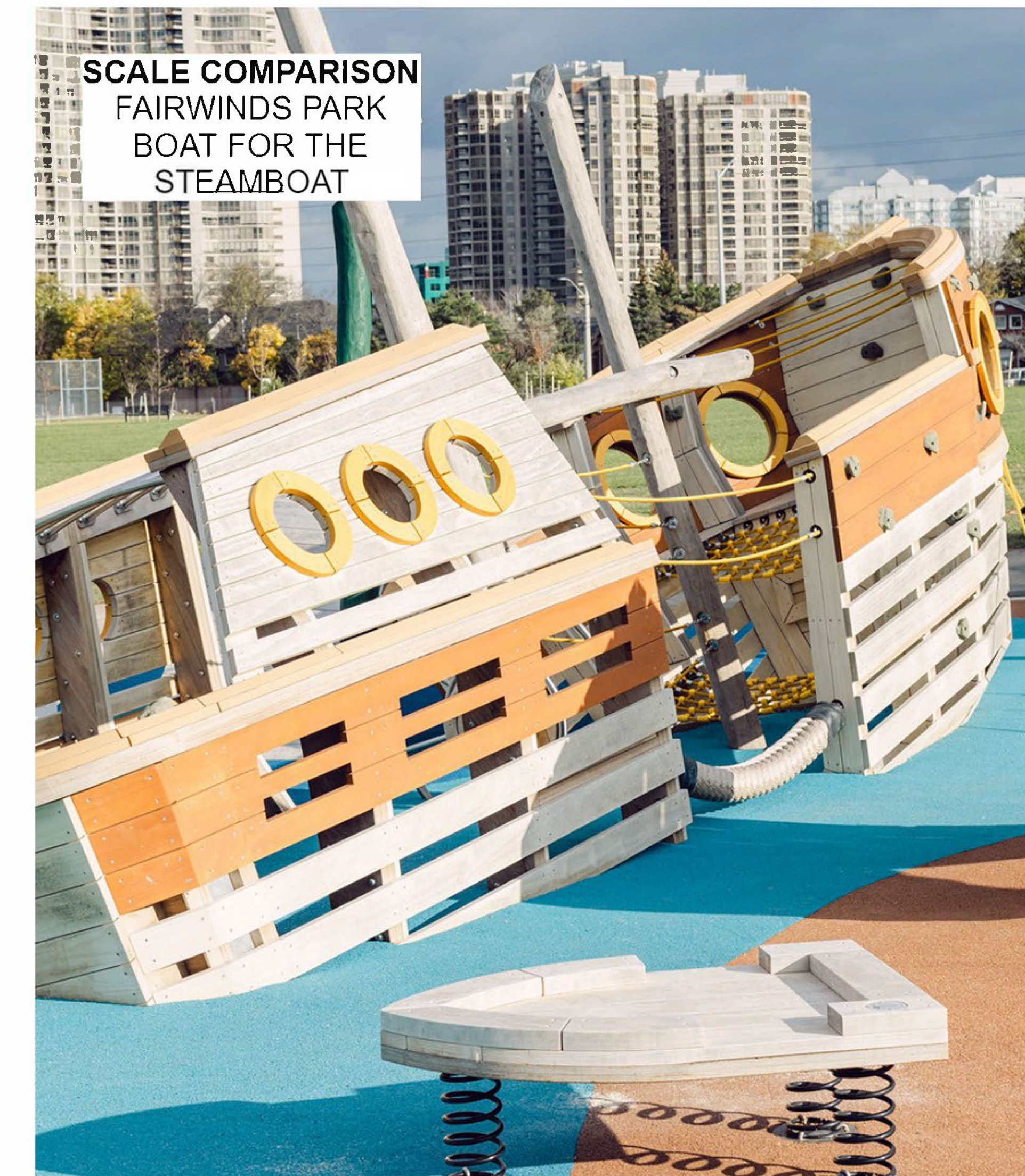
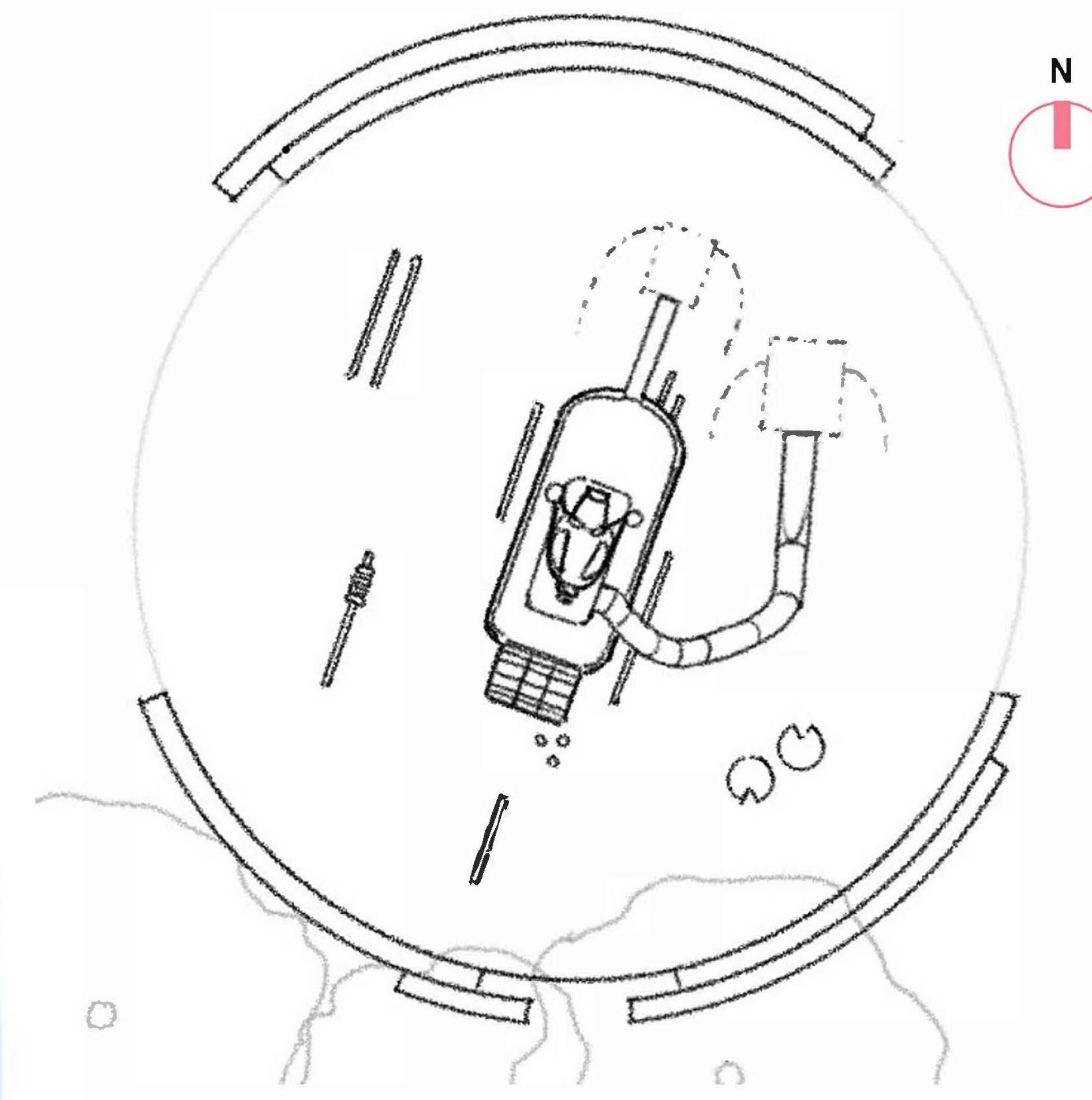
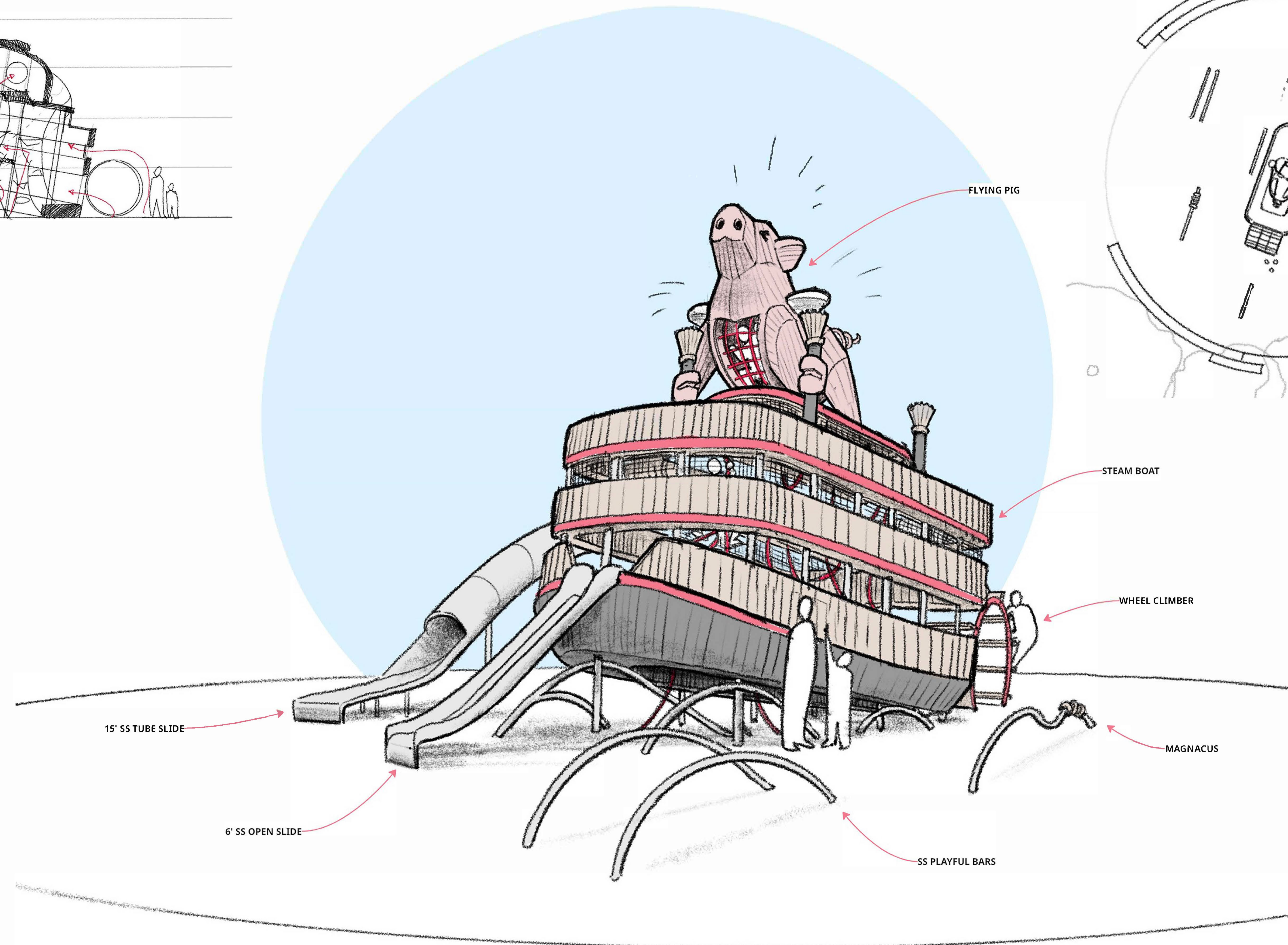
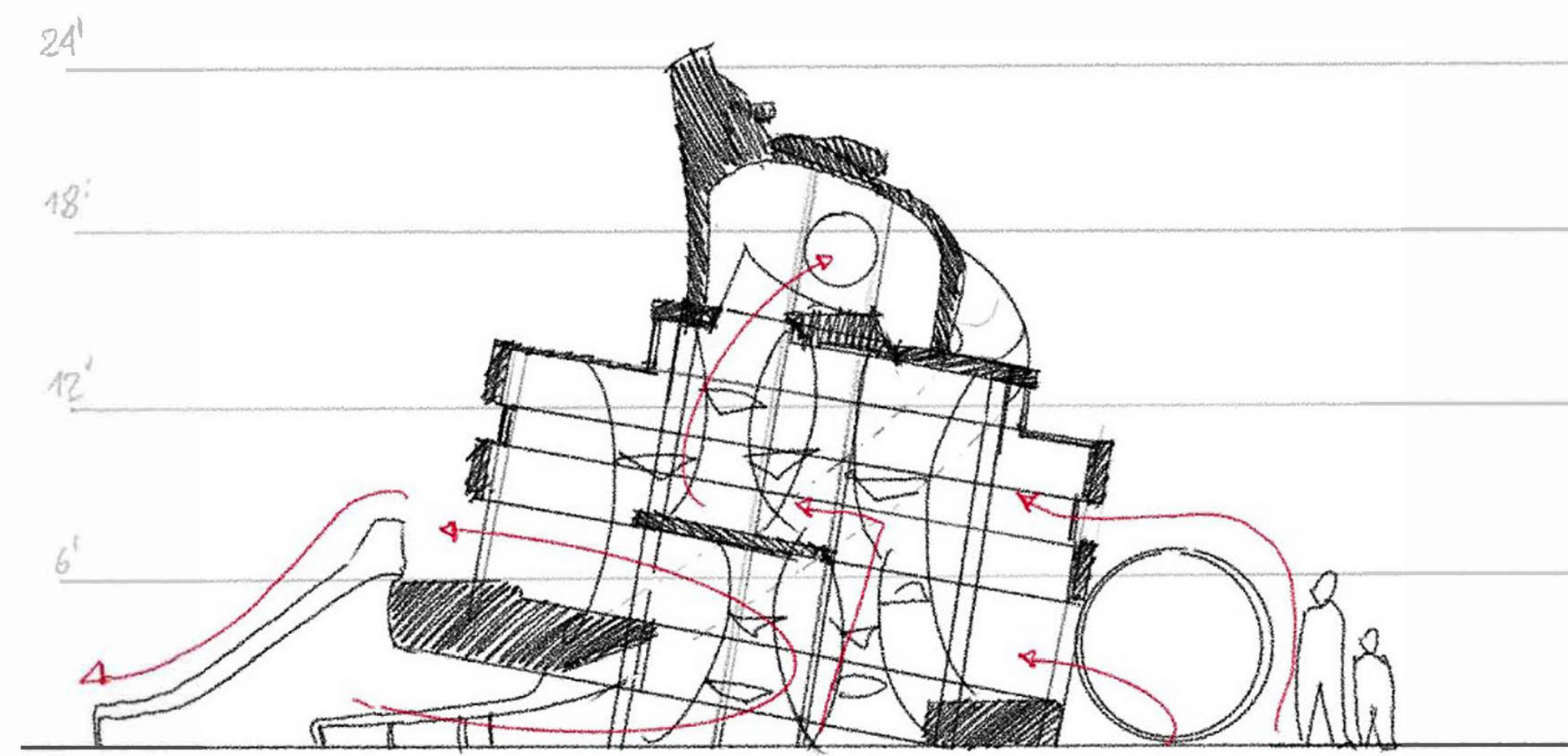

SAWYER POINT
CINCINNATI, OH

PIG POWERED BOAT
SKETCH

CINCINNATI RIBBONS



RED OR PINK LINES
REPRESENTING
PIGS AND CITY OF
CINCINNATI

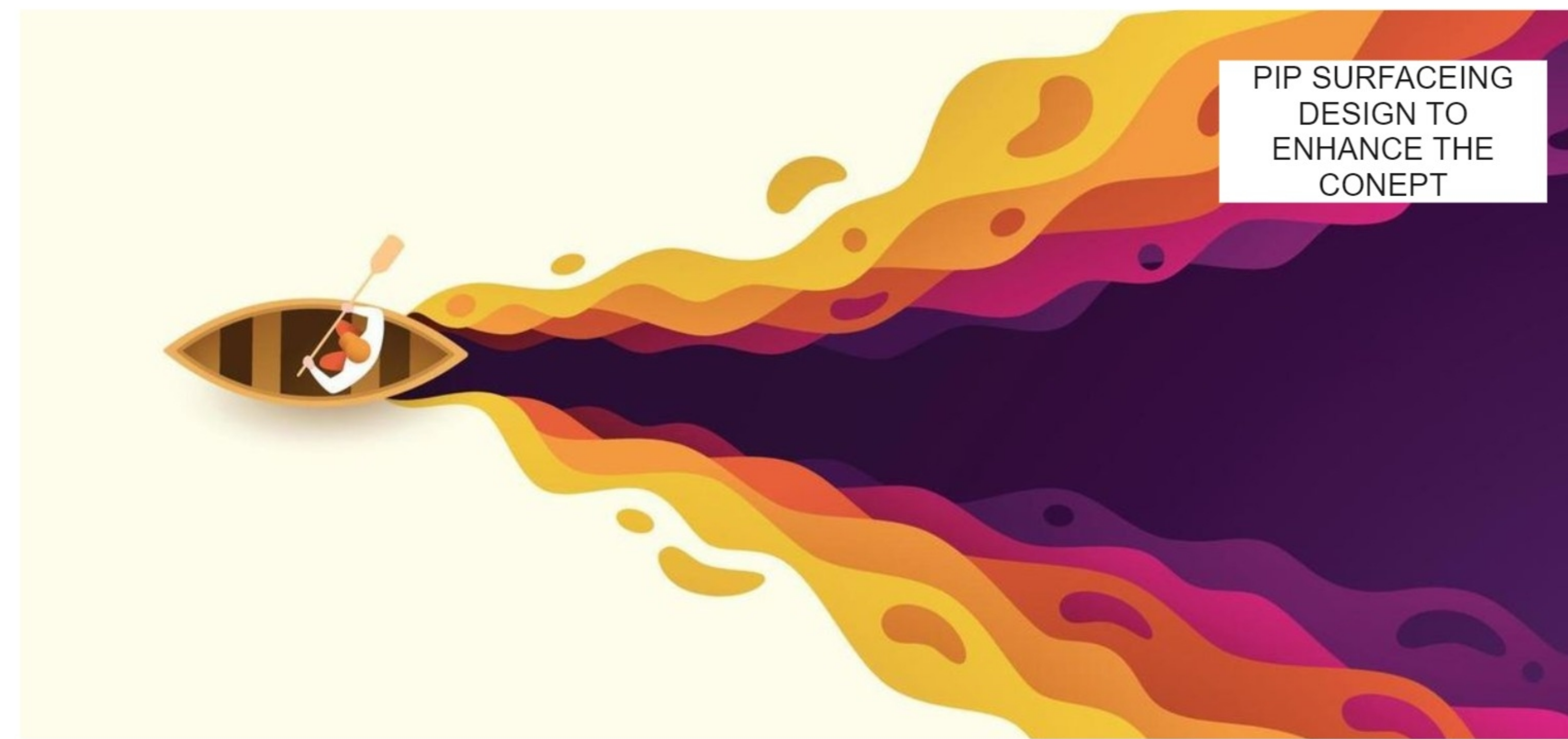

PIP SURFACING
DESIGN TO
ENHANCE THE
CONCEPT



REINTERPRETATION
OF THE 1000 HANDS
PLAYGROUND
ABSTRACTED BOAT

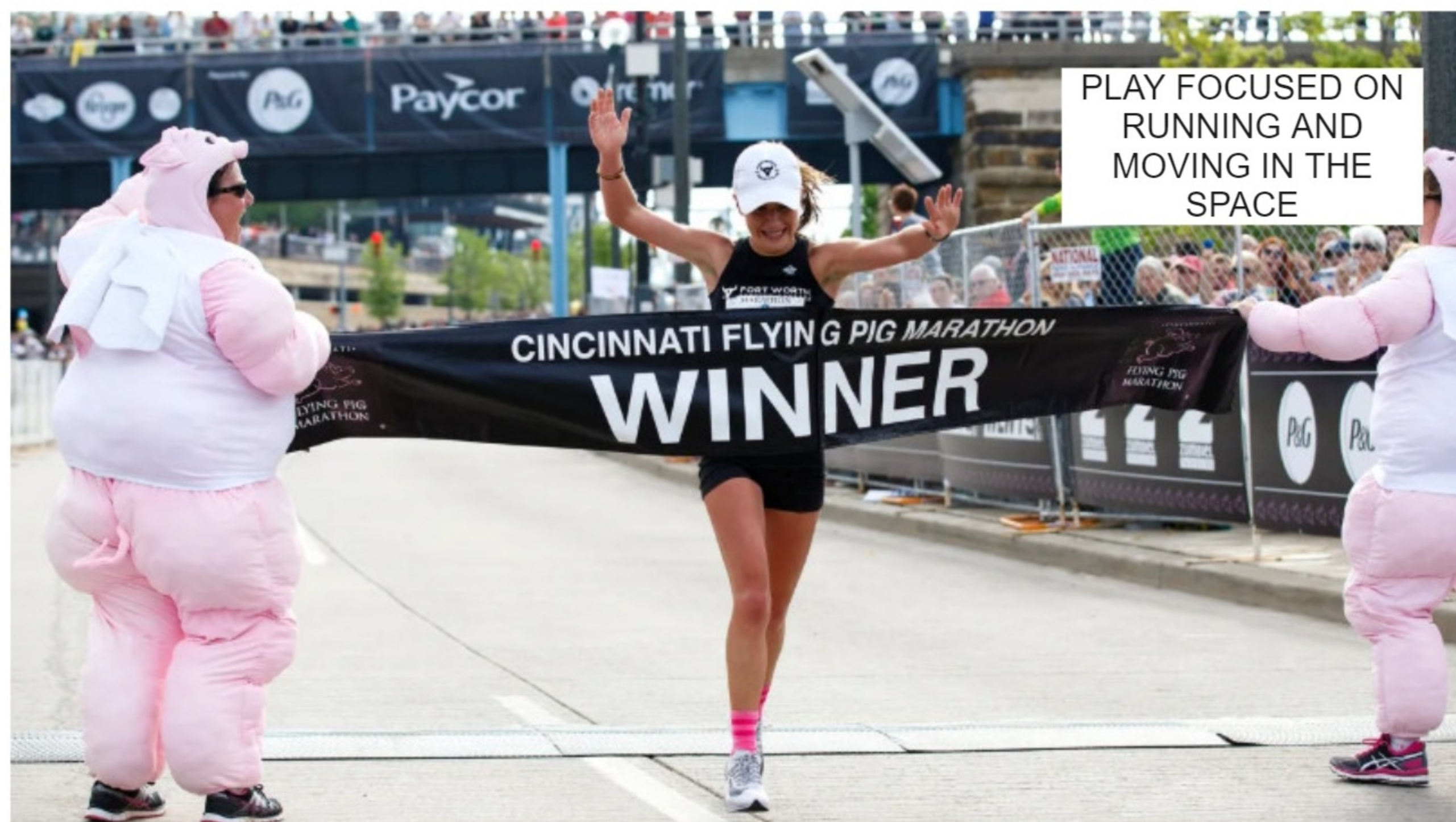

PLAY FOCUSED ON
RUNNING AND
MOVING IN THE
SPACE



RED LINES AS
REPRESENTATION
OF SPEED

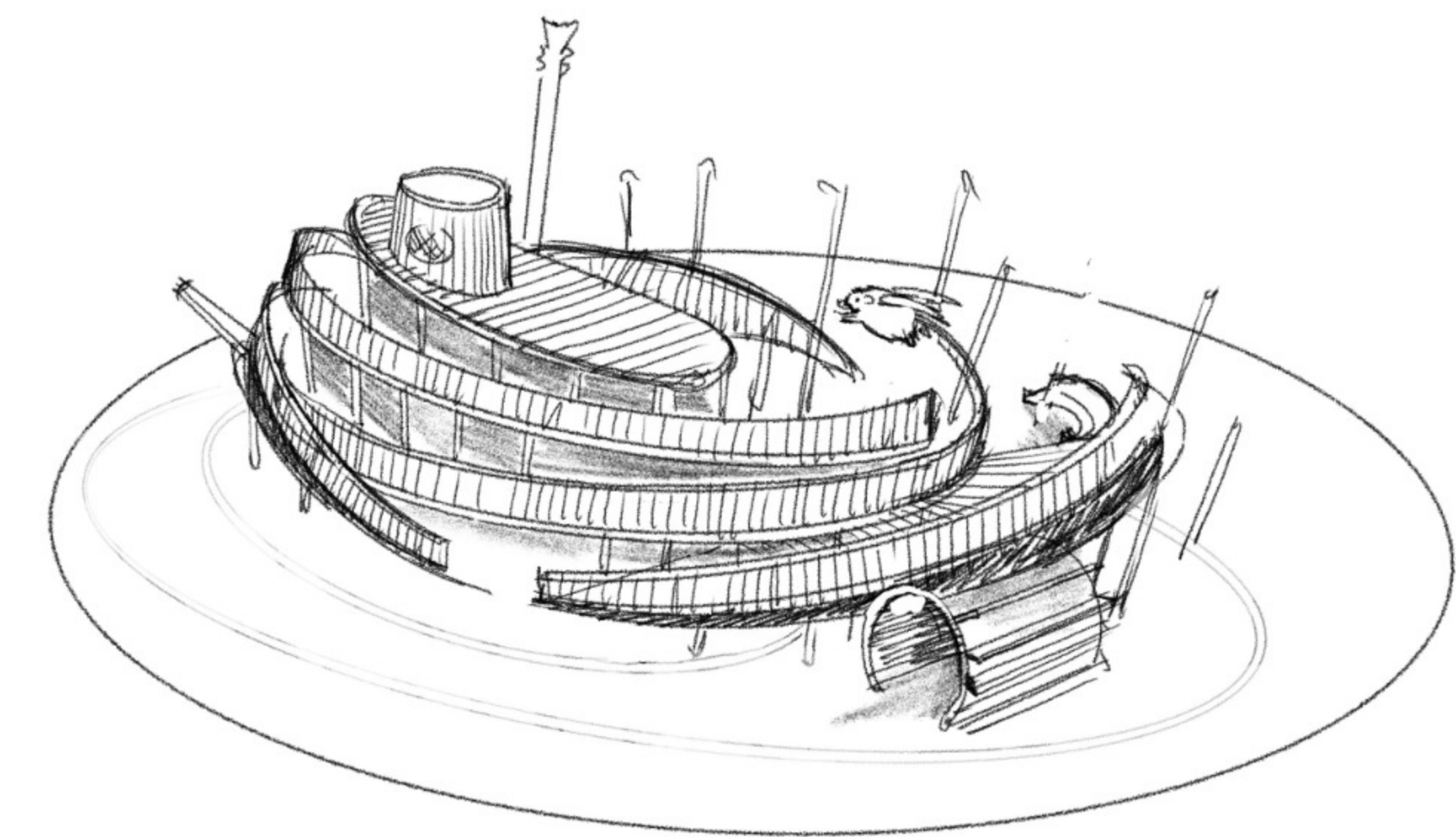

EXPLORATION SKETCH OF AN ABSTRACT STEAM BOAT
"EXPLODED" IN A LANDSCAPE OF LINES, RAMPS,
CORRIDORS AND BRIDGES



SAWYER POINT
CINCINNATI, OH

CINCINNATI RIBBONS
MOOD BOARD

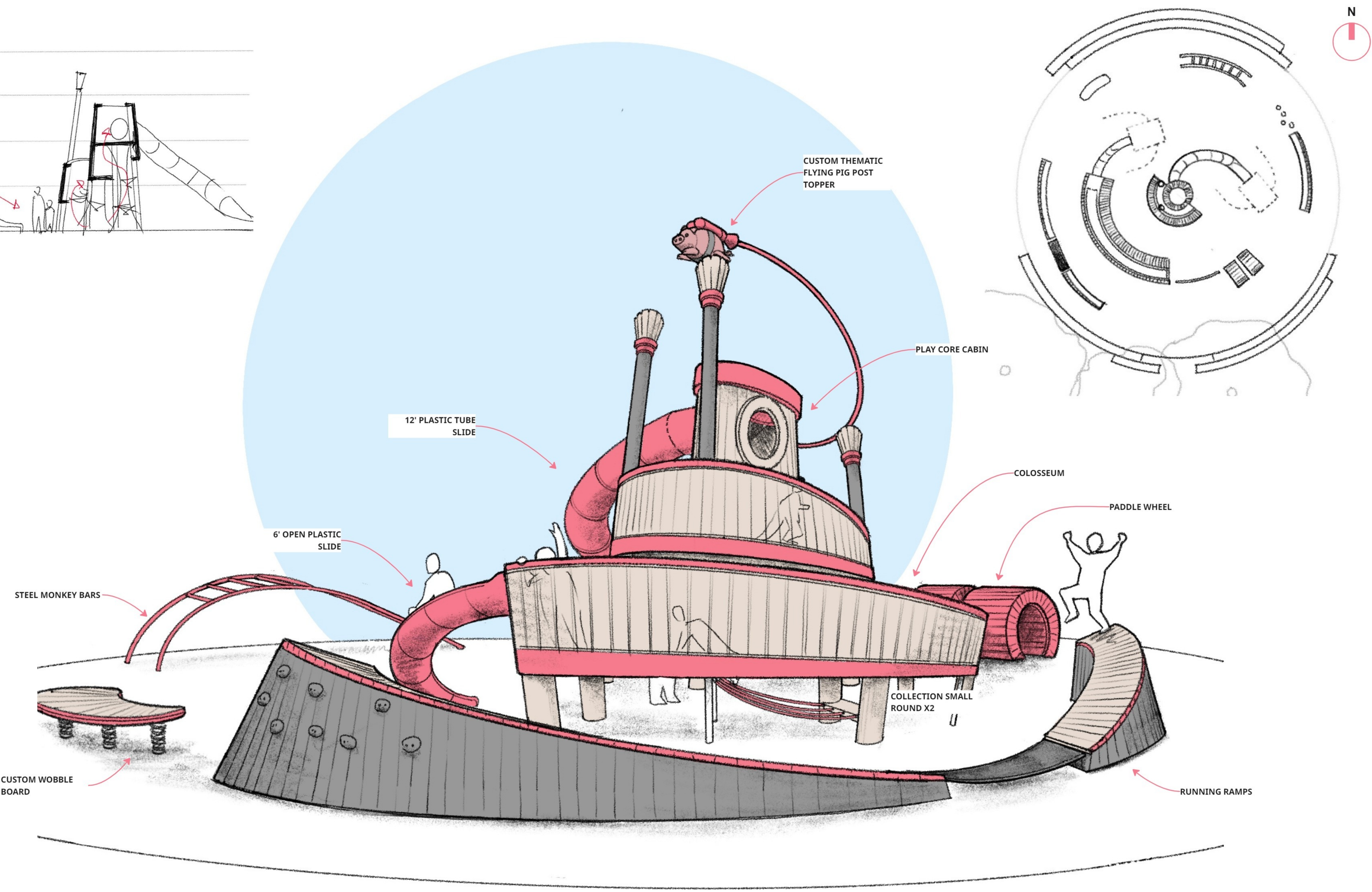
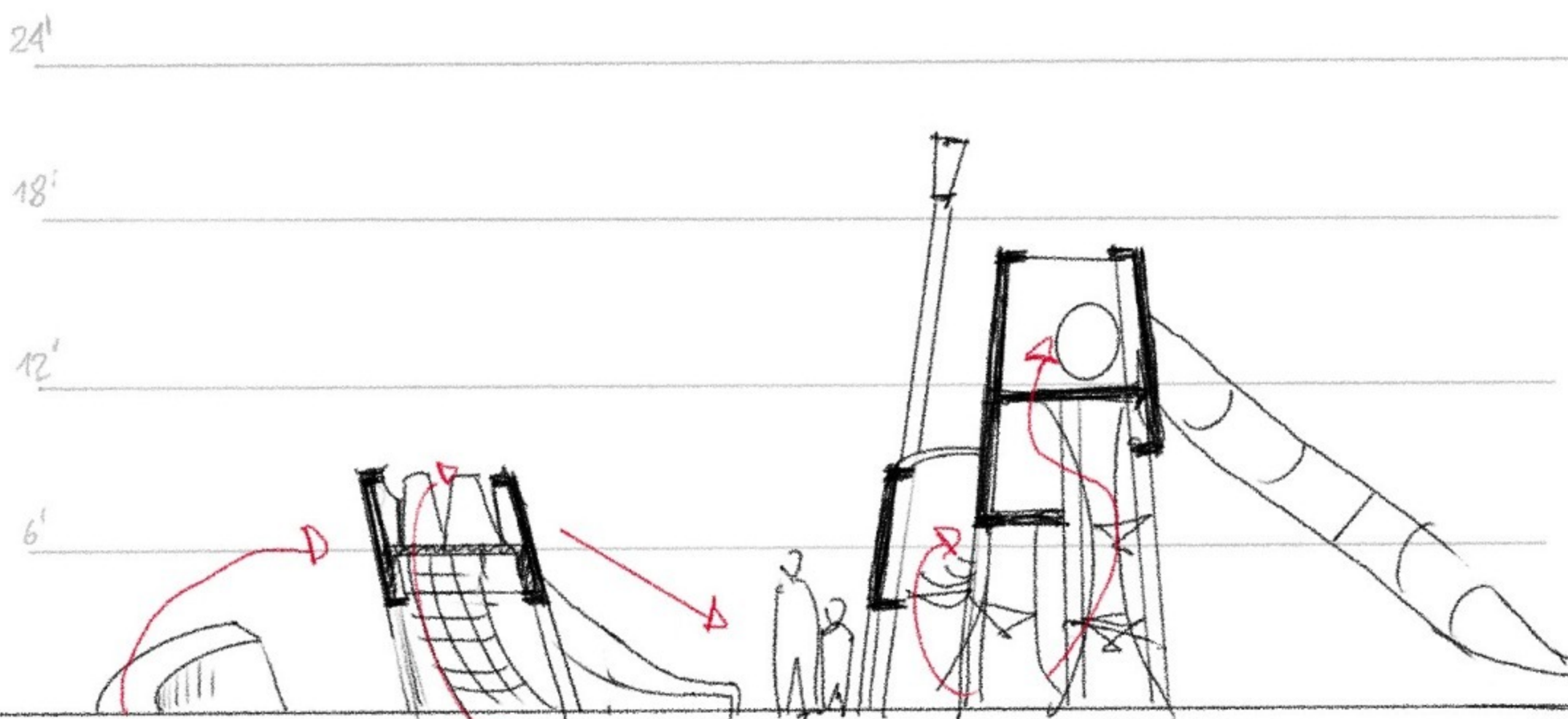

SCALE COMPARISON
PENNANT PARK FOR
CENTRAL CORE AND
COLOSSEUM



SCALE COMPARISON
CANDELA
PLAYGROUND FOR
RAMPS



SAWYER POINT
CINCINNATI, OH

CINCINNATI RIBBONS
SKETCH

FLYING PIGS



DISCOVERY ICON



WOBBLE BOARD



JR SCULPTURE

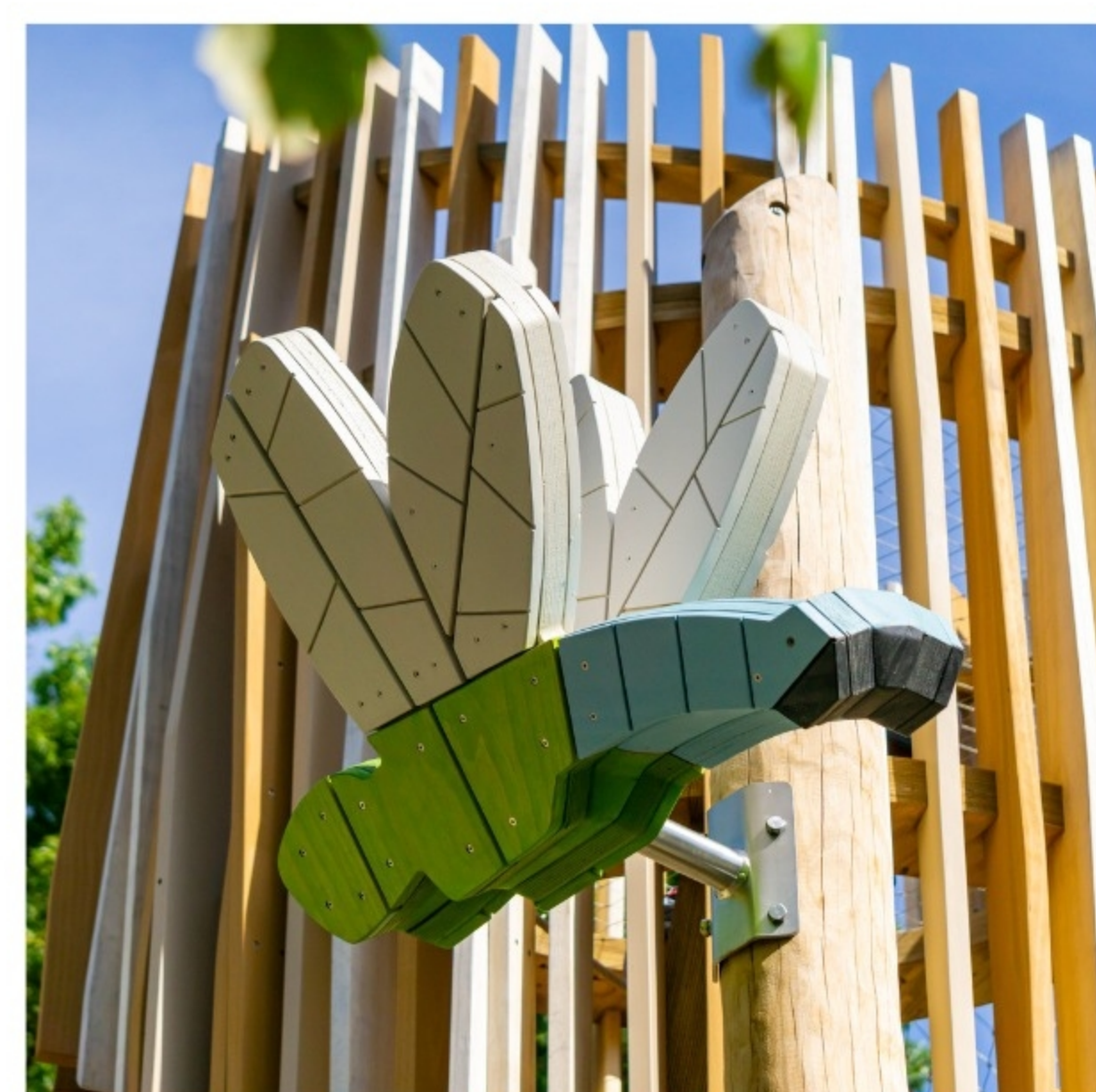

POST TOPPER



JR CRITTER



SR SCULPTURE

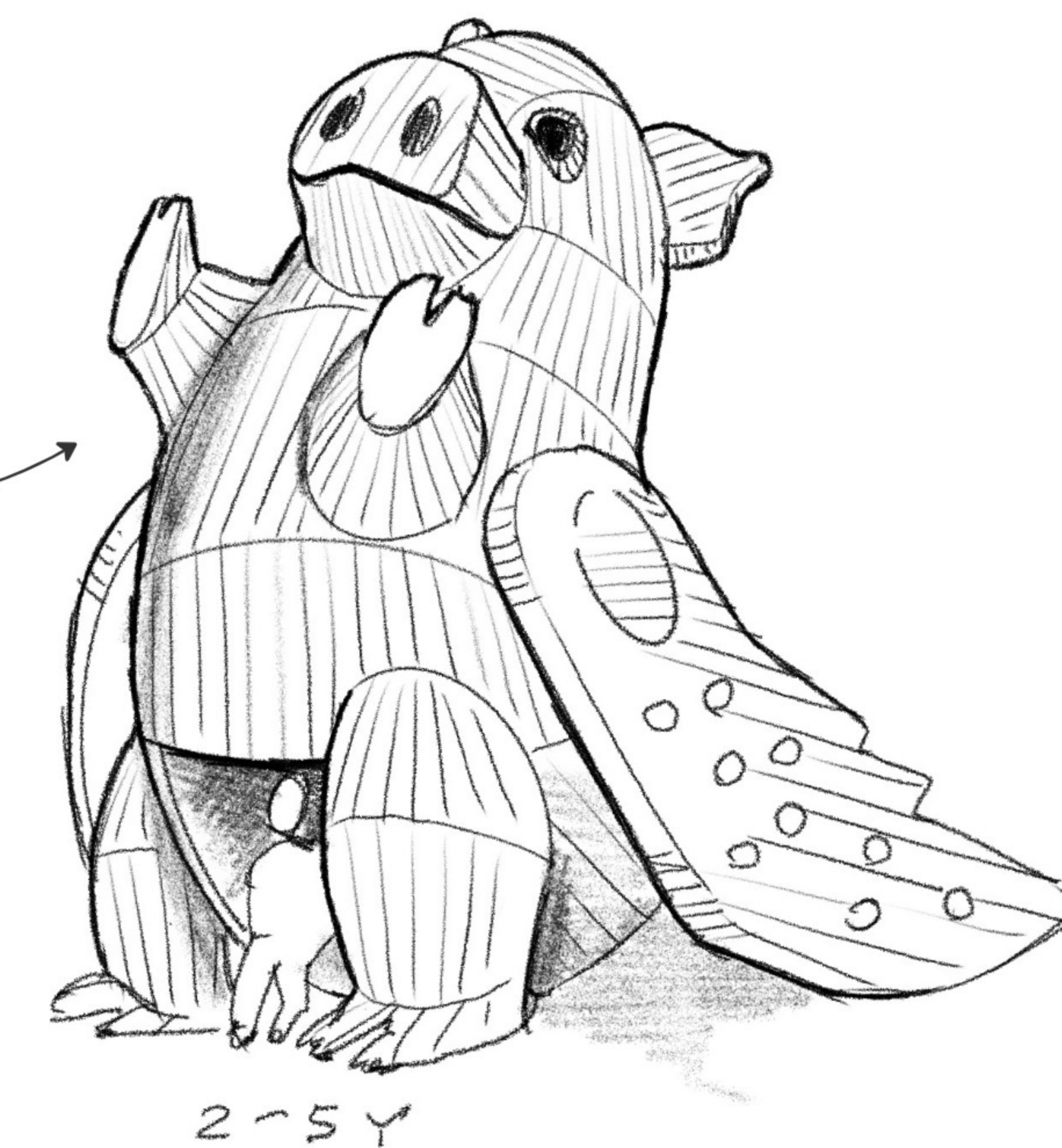

SKETCH REPRESENTING A FLYING PIG JR SCULPTURE,
AGEGROUP 2 TO 5 YEARS OLD

SUBTLE

OBVIOUS

PIG POWERED BOAT



REPRESENTATION
OF A STEAM BOAT



WIMSICAL
COMPOSITION OF
PIG AND BOAT

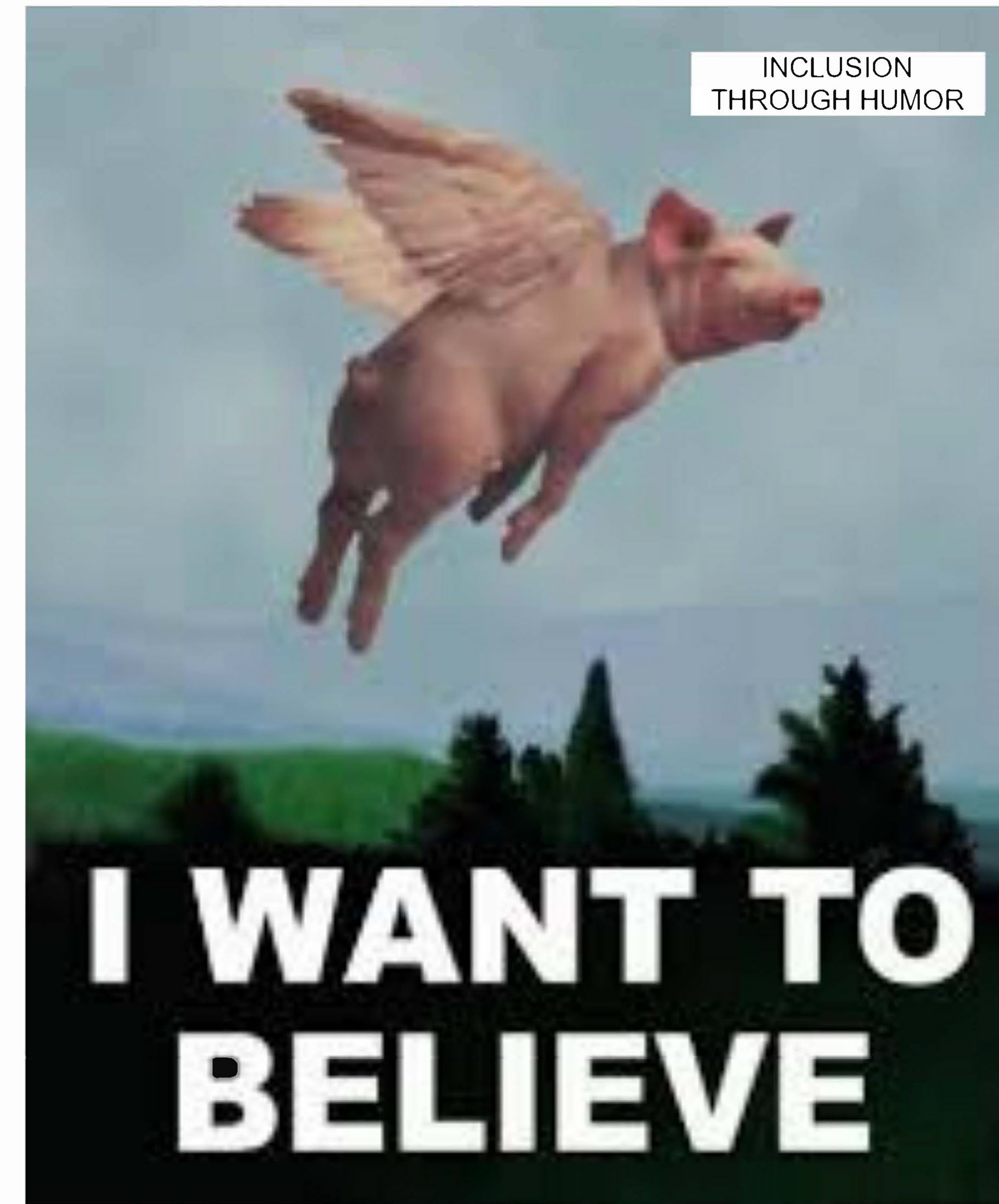

INCLUSION
THROUGH HUMOR

I WANT TO
BELIEVE



REPRESENTATION
OF THE FLYING PIG

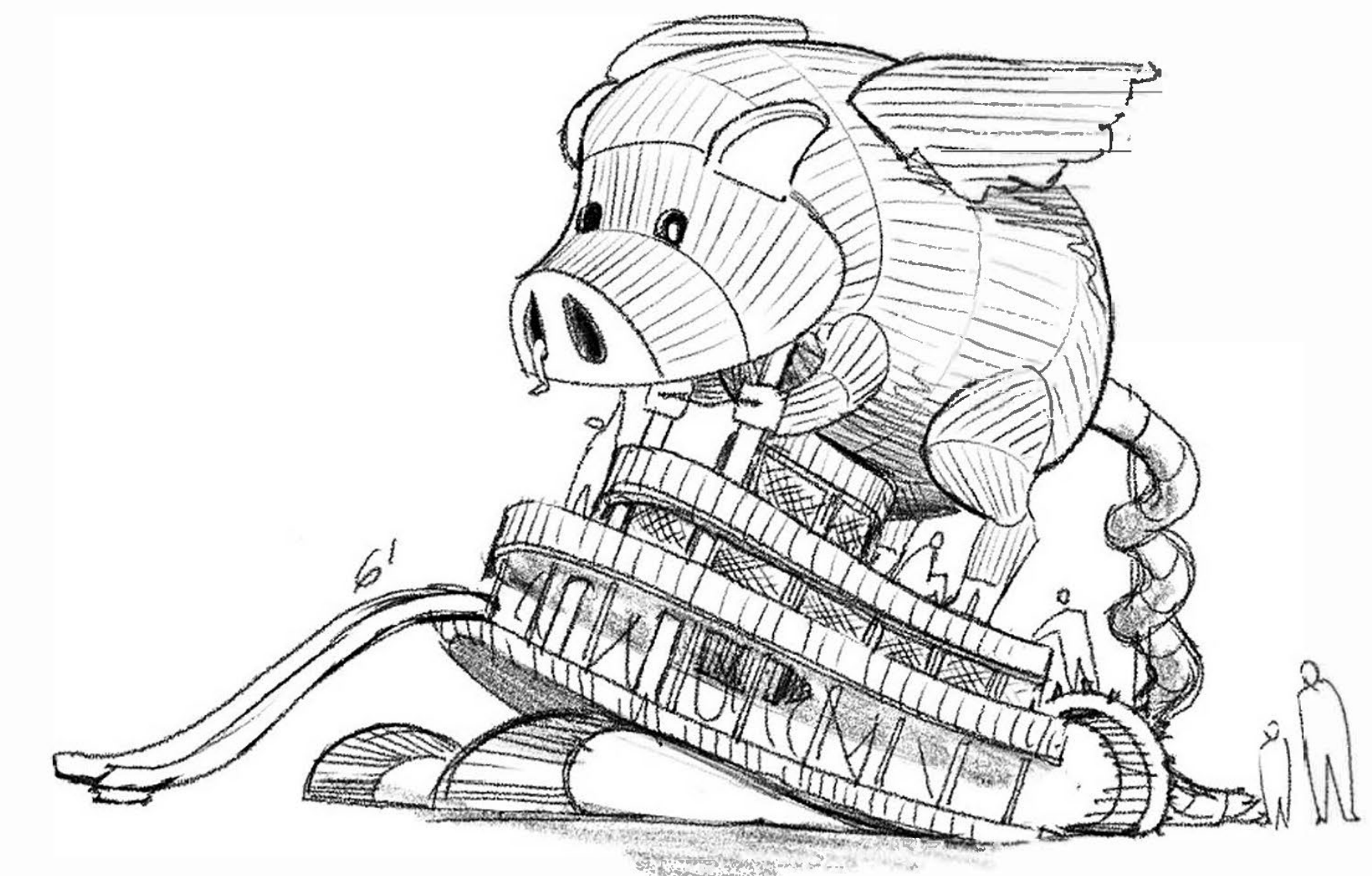

EXPLORATION SKETCH OF A PIG LIFTING A STEAMBOAT
FROM THE RIVER

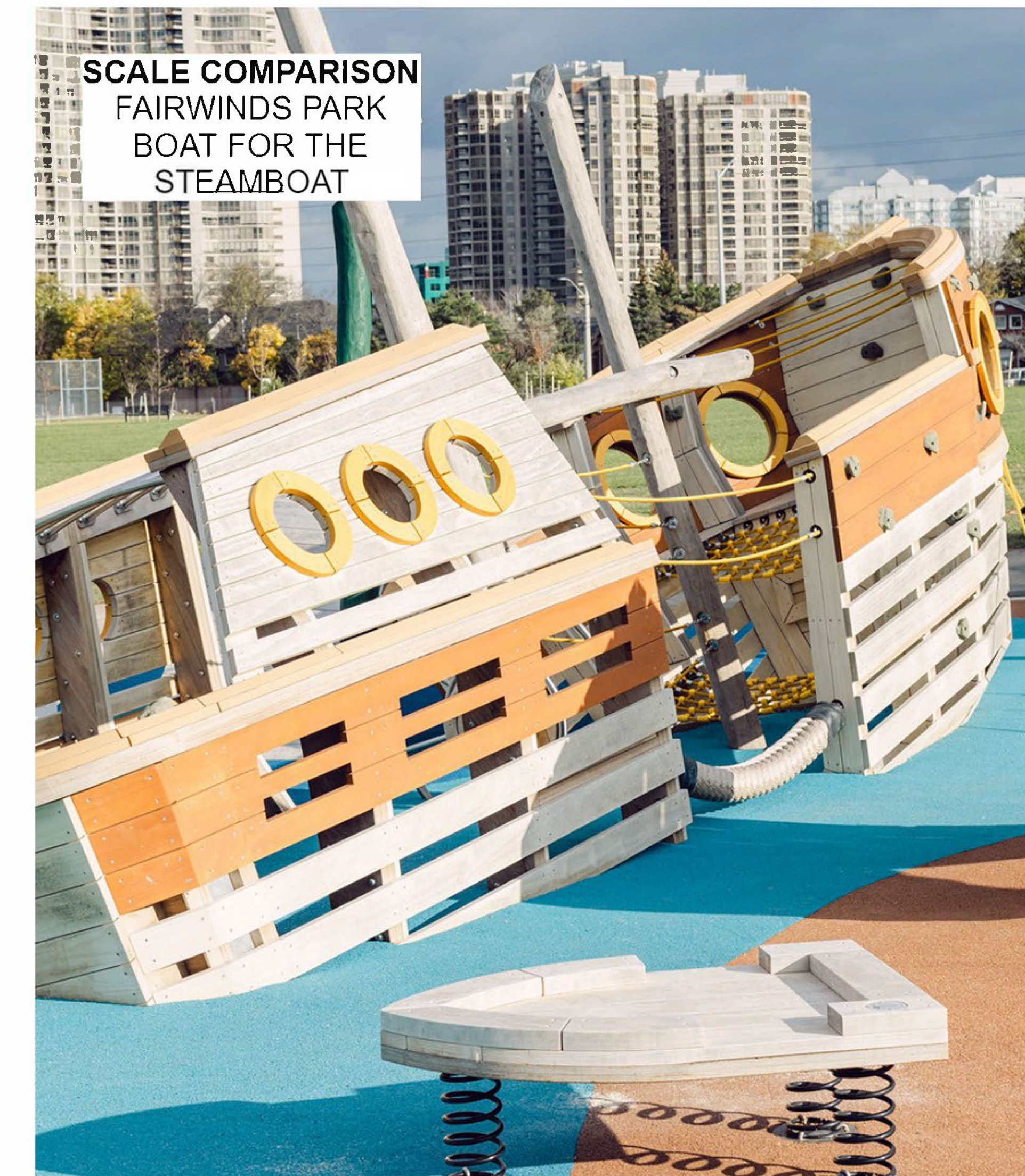
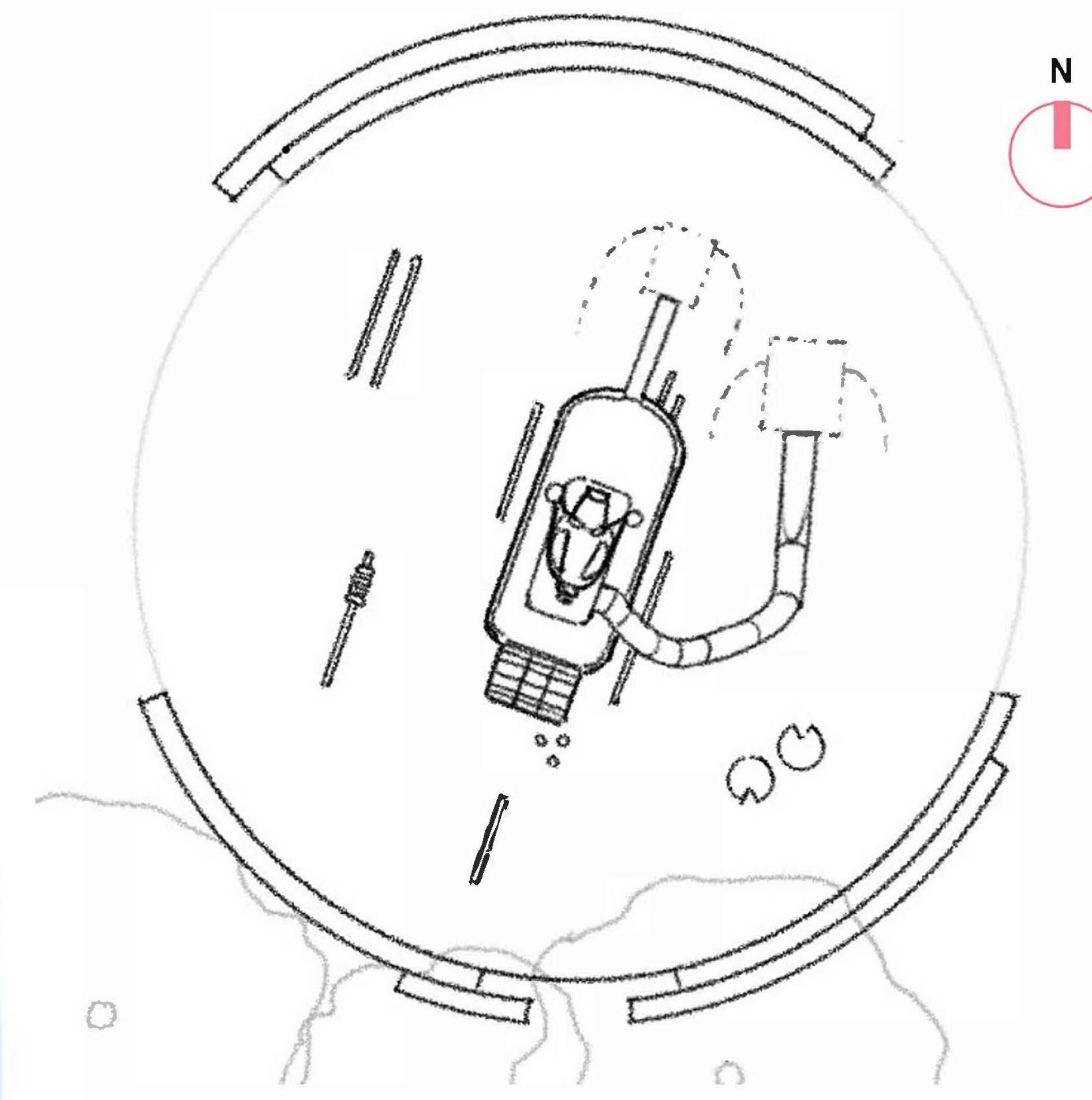
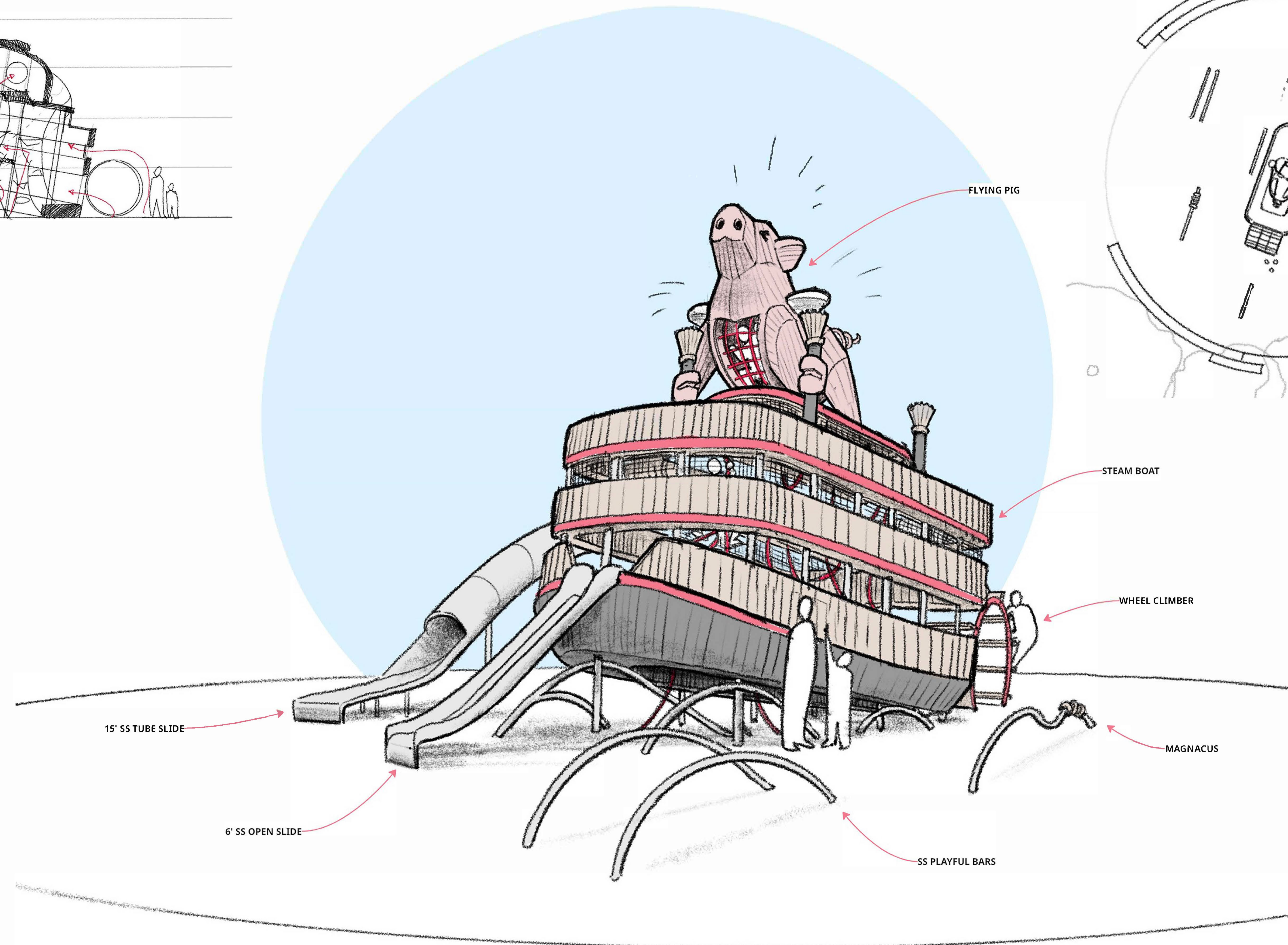
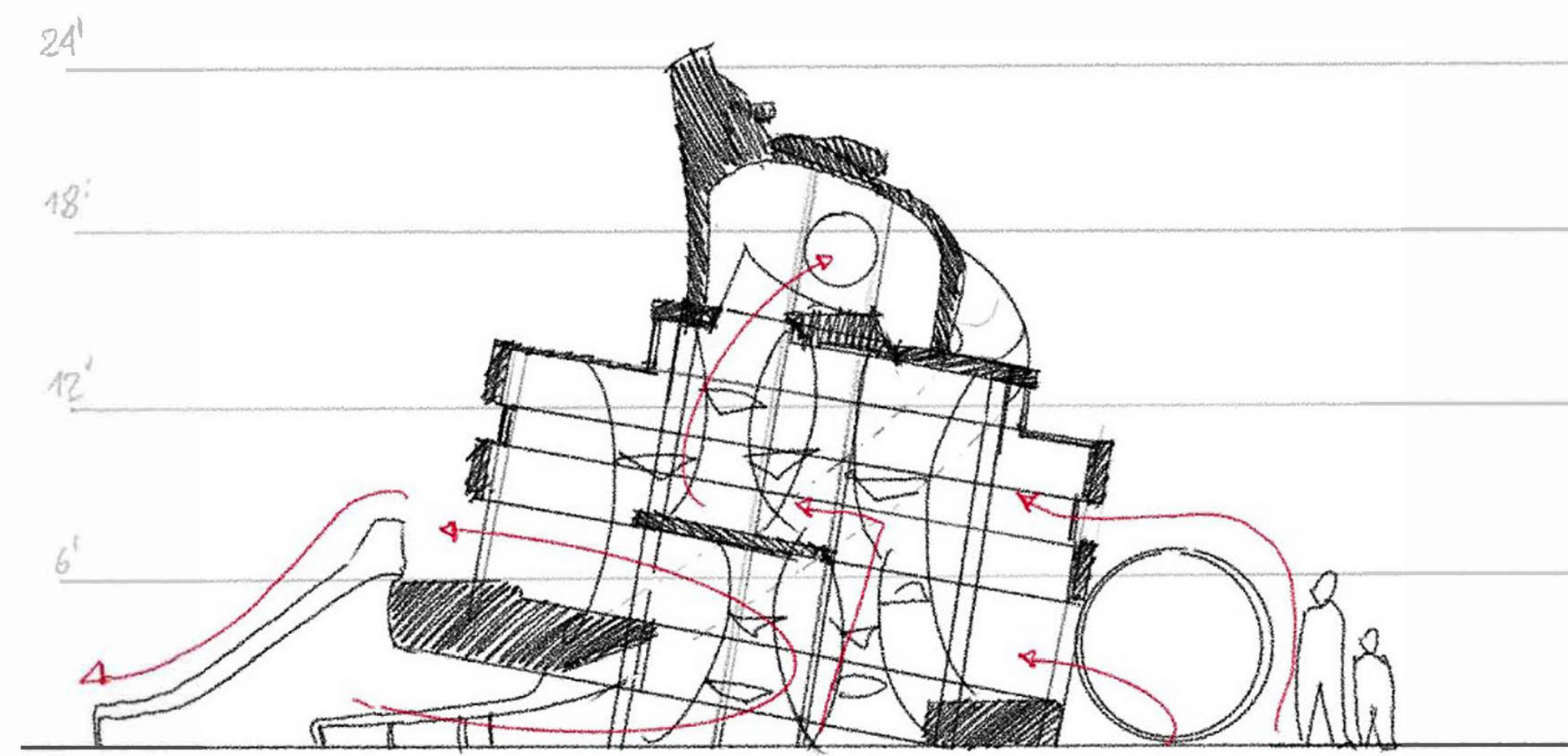

SAWYER POINT
CINCINNATI, OH

PIG POWERED BOAT
SKETCH

CINCINNATI RIBBONS



RED OR PINK LINES
REPRESENTING
PIGS AND CITY OF
CINCINNATI

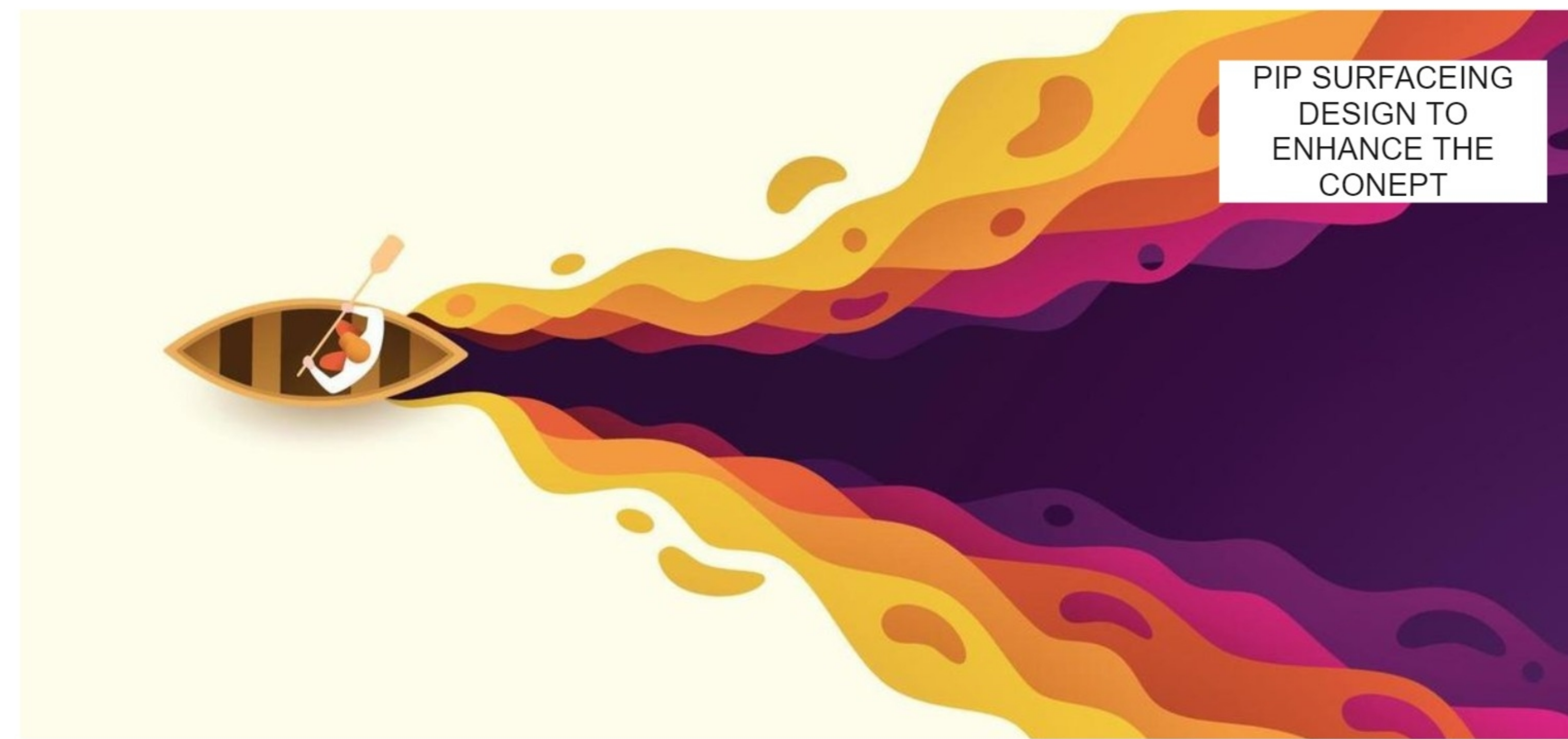

PIP SURFACING
DESIGN TO
ENHANCE THE
CONCEPT



REINTERPRETATION
OF THE 1000 HANDS
PLAYGROUND
ABSTRACTED BOAT

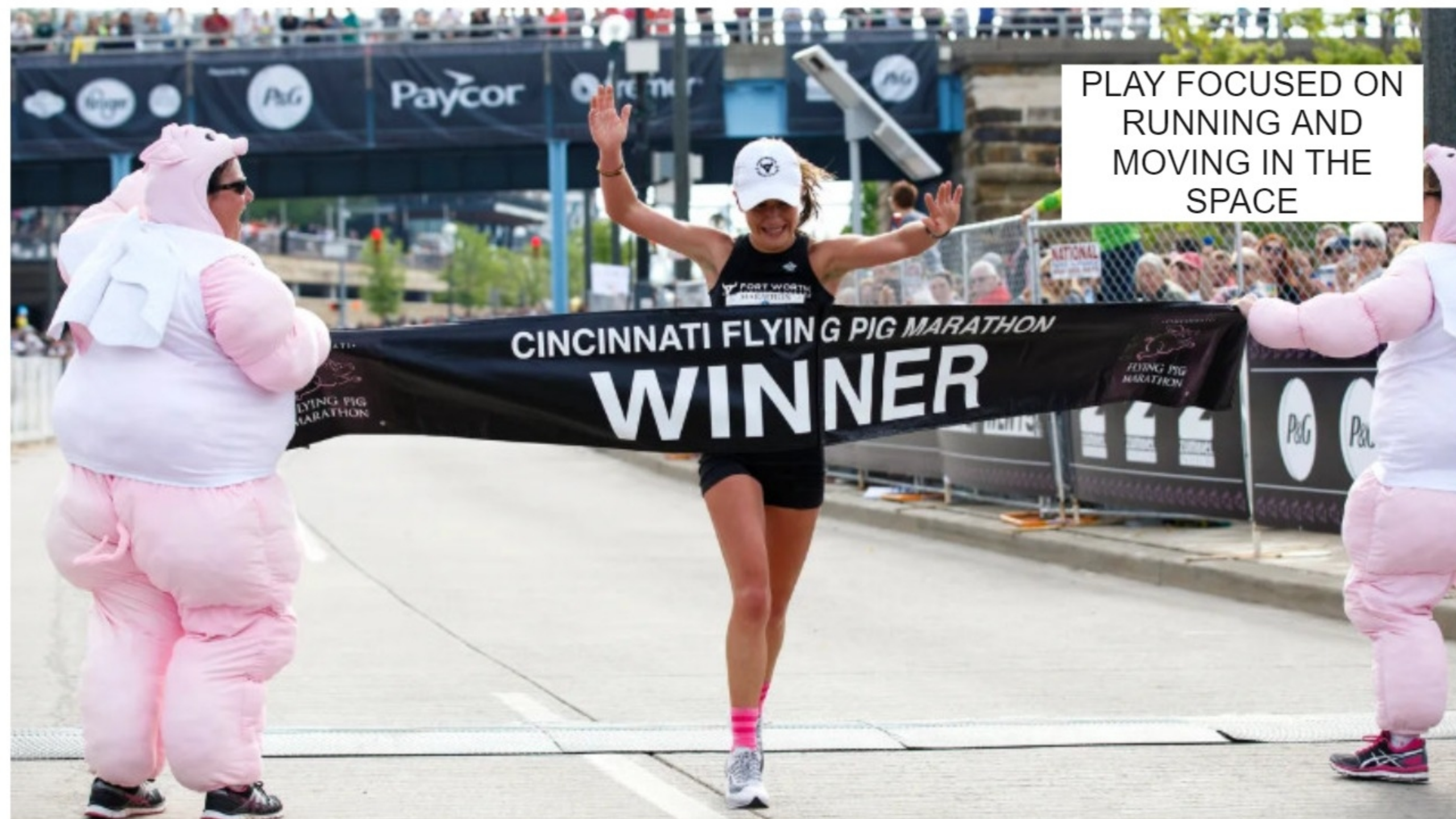

PLAY FOCUSED ON
RUNNING AND
MOVING IN THE
SPACE



RED LINES AS
REPRESENTATION
OF SPEED

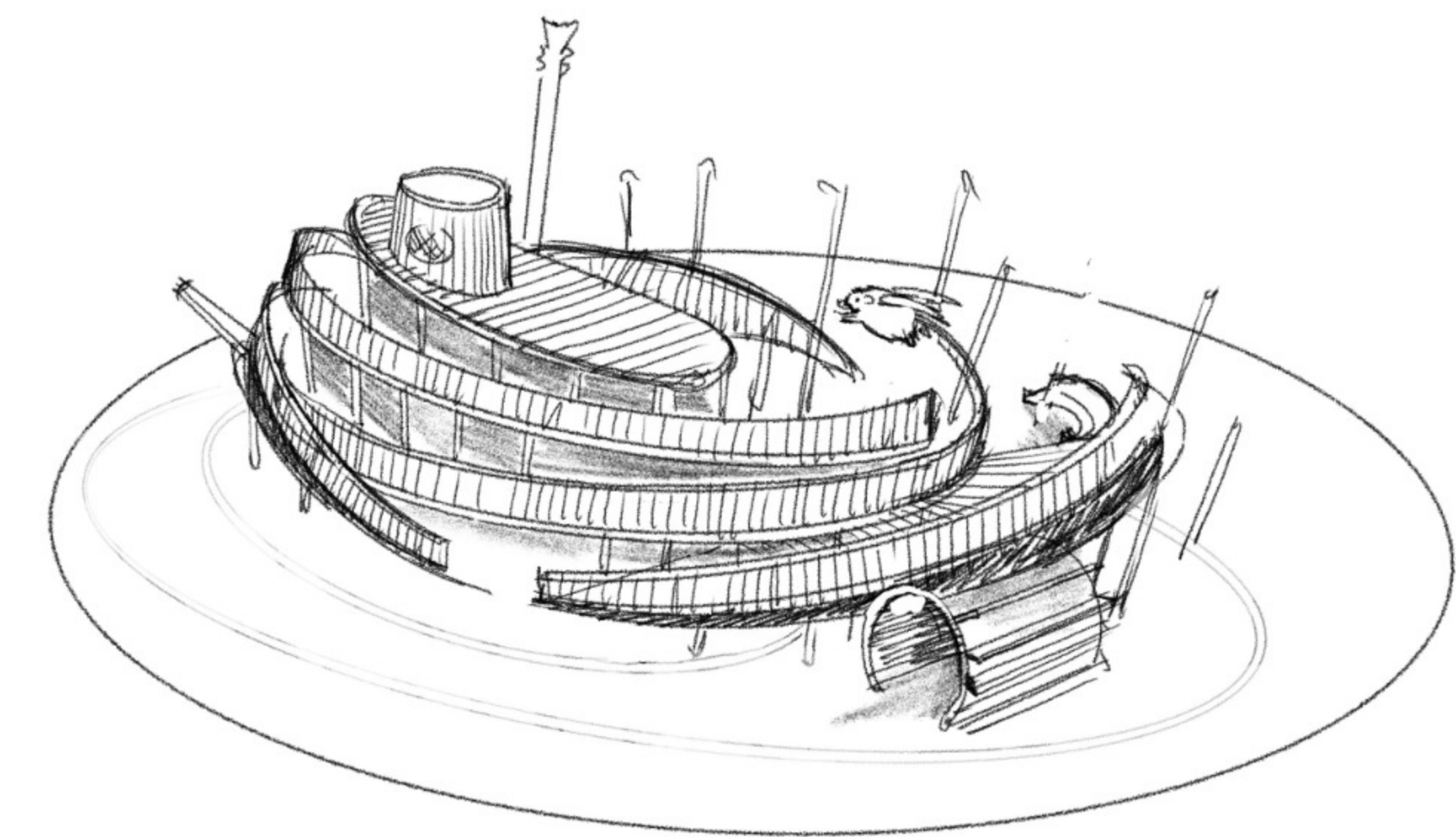

EXPLORATION SKETCH OF AN ABSTRACT STEAM BOAT
"EXPLODED" IN A LANDSCAPE OF LINES, RAMPS,
CORRIDORS AND BRIDGES

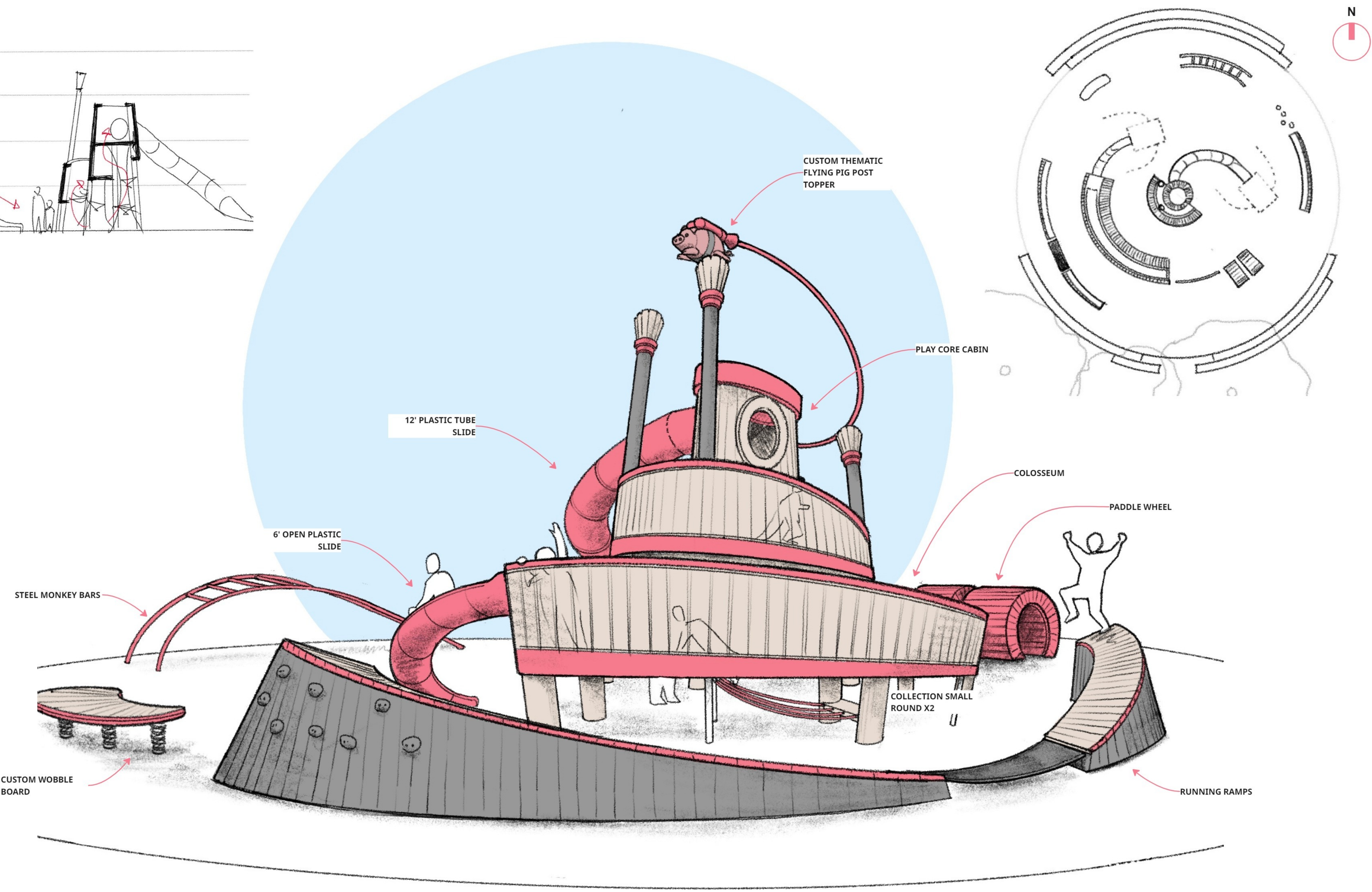
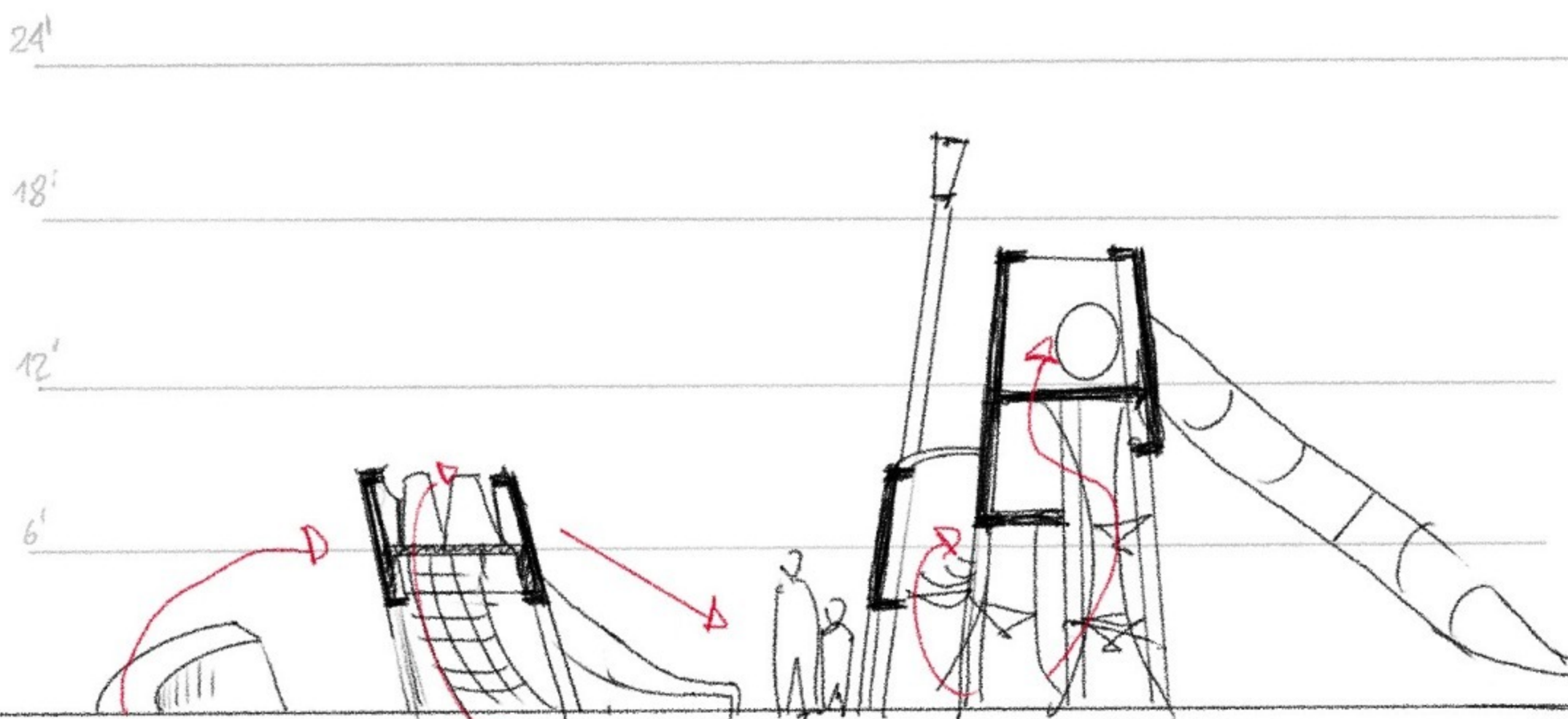

SCALE COMPARISON
PENNANT PARK FOR
CENTRAL CORE AND
COLOSSEUM



SCALE COMPARISON
CANDELA
PLAYGROUND FOR
RAMPS



SAWYER POINT
CINCINNATI, OH

CINCINNATI RIBBONS
SKETCH

FLYING PIGS



DISCOVERY ICON



WOBBLE BOARD



JR SCULPTURE

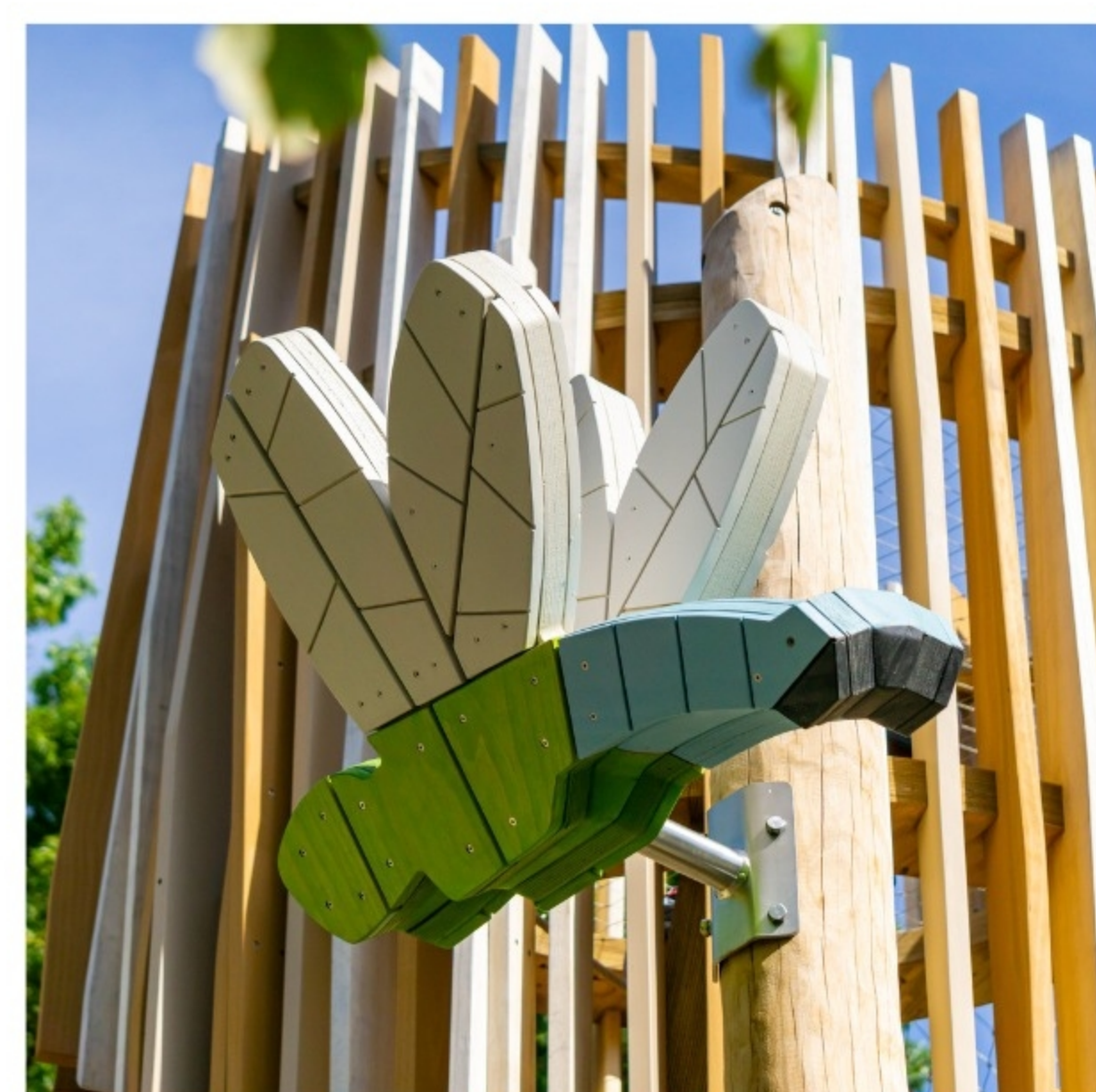

POST TOPPER



JR CRITTER



SR SCULPTURE

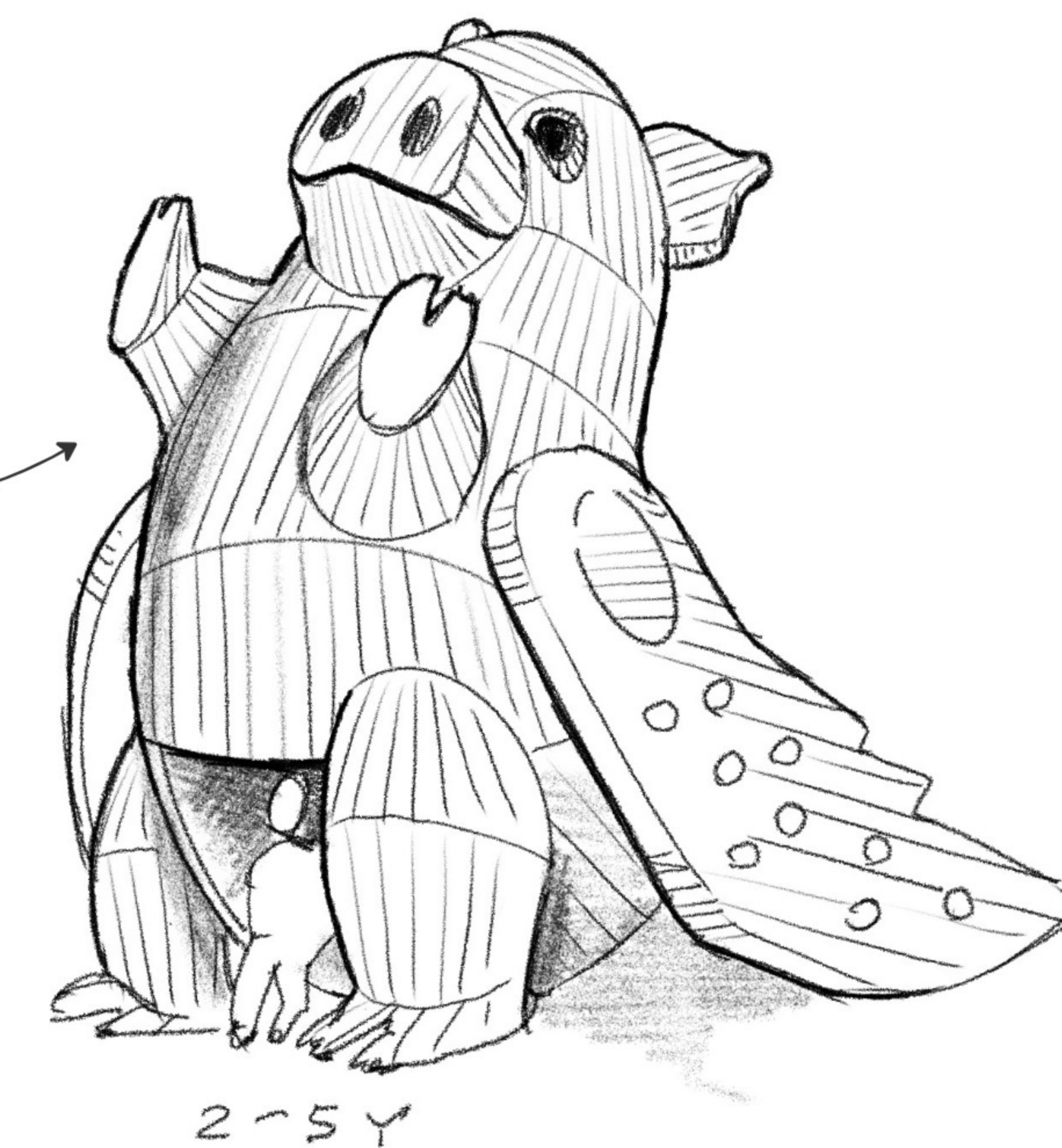

SKETCH REPRESENTING A FLYING PIG JR SCULPTURE,
AGEGROUP 2 TO 5 YEARS OLD

SUBTLE —————> OBVIOUS