

PROPERTY ADDRESS

1A	5400 MEDPACE WAY
1B	5350 MEDPACE WAY
2	5375 MEDPACE WAY
3	5365 MEDPACE WAY
4A	5355 MEDPACE WAY
5	5345 MEDPACE WAY
10	5425 HETZEL STREET
12	5401 MEDPACE WAY
13	5340 HETZEL STREET
14	5401 HETZEL STREET

Revisions:
Issue Date: 8-18-2023

**RBM DEVELOPMENT/
MEDPACE**

CINCINNATI, OHIO

**MEDPACE
CAMPUS MAP**

Project No.

13100

1A

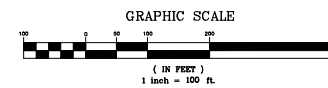

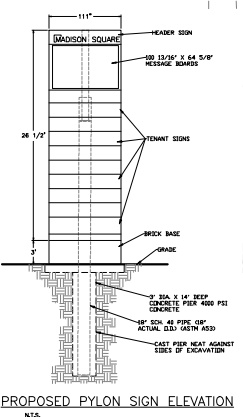
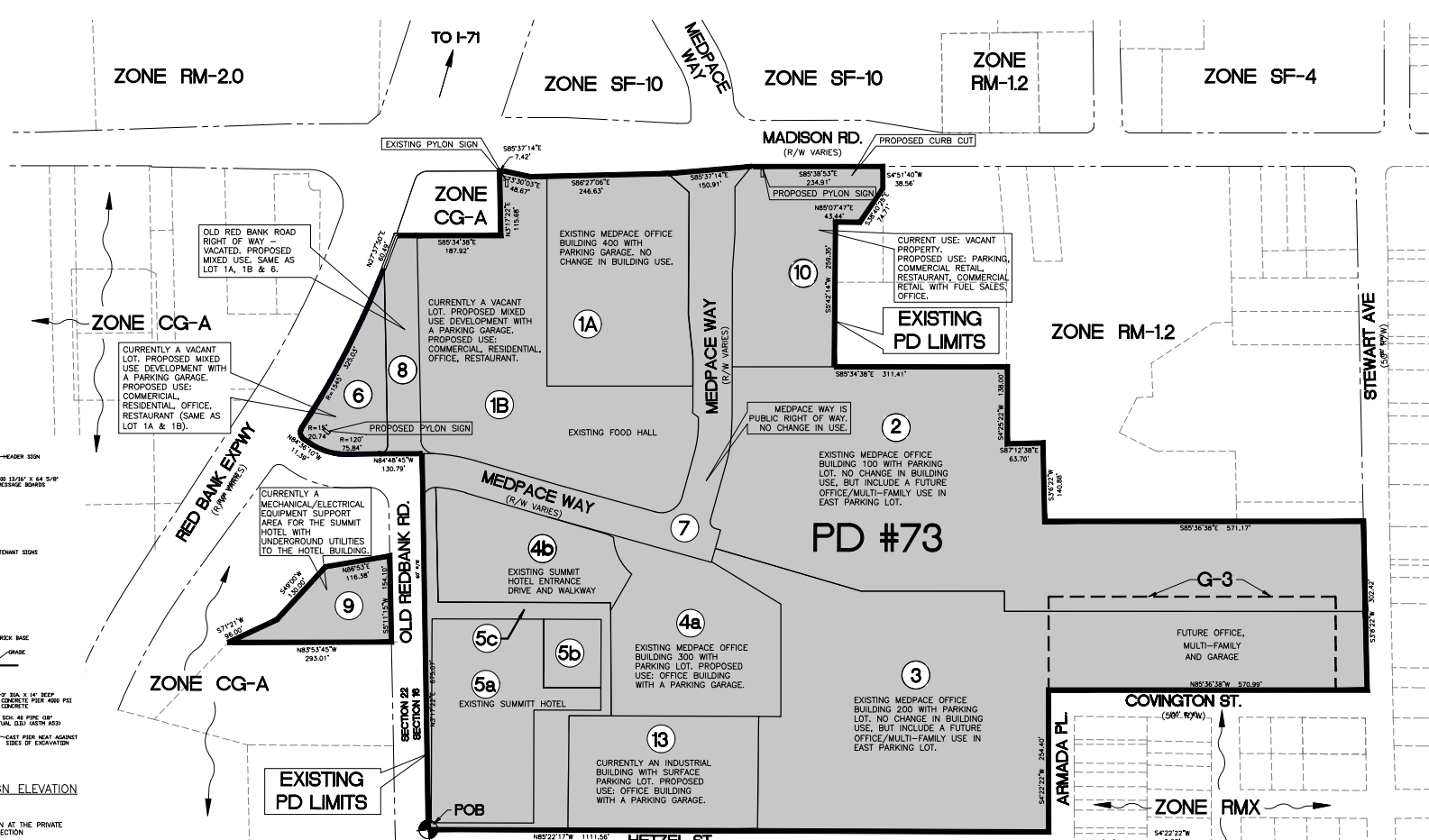

PROPOSED PYLON SIGN ELEVATION
N.T.S.

NOTE: SIMILAR IN NATURE AS THE SIGN AT THE PRIVATE DRIVE & MADISON ROAD INTERSECTION

NOTE: PYLON SIGN TO MATCH EXISTING SIGN
PRIVATE NORTH-SOUTH DRIVEWAY AT MADISON ROAD

LEGEND

5-15-2023
11-11-2022
7-13-2022
8-25-2021
Revisions: 9-16-2016
Issue Date: 9-7-2016

RBM DEVELOPMENT

CINCINNATI, OHIO
PROPERTY AND ZONING MAP

Project No. 13100
1

Plan ID #	Parcel ID	Record Document	Name	Area (Ac)
1A	036-0001-0323 (ground)	O.R. 11275 Pg 1564	Port of Greater Cincinnati Development Authority	2.21
1B	036-0001-0326	O.R. 12402 PG 2203	400 Medpace Way LLC	3.566
2	036-0001-0321	O.R. 11551 Pg 1447	100 Medpace Way LLC	7.06
3	036-0001-0303	O.R. 11742 Pg 1329	200 Medpace Way LLC	6.914
4a	036-0001-0309	O.R. 11742 Pg 1336	300 Medpace Way LLC	1.850
4b	036-0001-0310	O.R. 13119 Pg 1776	Port of Greater Cincinnati Development Authority	1.265
5a	036-0001-0319 (garage)	O.R. 13119 Pg 1776	700 Medpace Way LLC	1.699
5b	036-0001-0311 (hotel)		Port of Greater Cincinnati Development Authority	0.287
5c	036-0001-0313 (ground)		Port of Greater Cincinnati Development Authority	0.87
6	051-0008-0018	O.R. 12275 Pg 1564	404 Medpace Way LLC	0.613
7	036-0001-0332 (Portion of Medpace Way R/W*)		City of Cincinnati	1.941
8	036-0001-0329		400 Medpace Way LLC	0.529
9	051-0008-0019	Plat Book 350 Pg 92	Port of Greater Cincinnati Development Authority	0.605
10	036-0001-0328	Plat Book 11 Pg 56	Medpace INC	1.165
11	036-0001-0327	Plat Book 11 Pg 56	Medpace INC	0.41
12	036-0001-0322	O.R. 13579 Pg 1693	Madison Road Real Estate LLC	1.659
13	036-0001-0008	O.R. 13243 Pg 2785	Madison Road Real Estate LLC	1.598
14	036-0001-0013		Endless Earth Enterprises LLC	1.672
Total				35.913

NOTE: MEDPACE WAY RIGHT OF WAY PARCEL REFLECTS TO ROAD IMPROVEMENTS COMPLETED IN 2020.

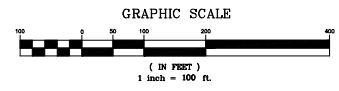

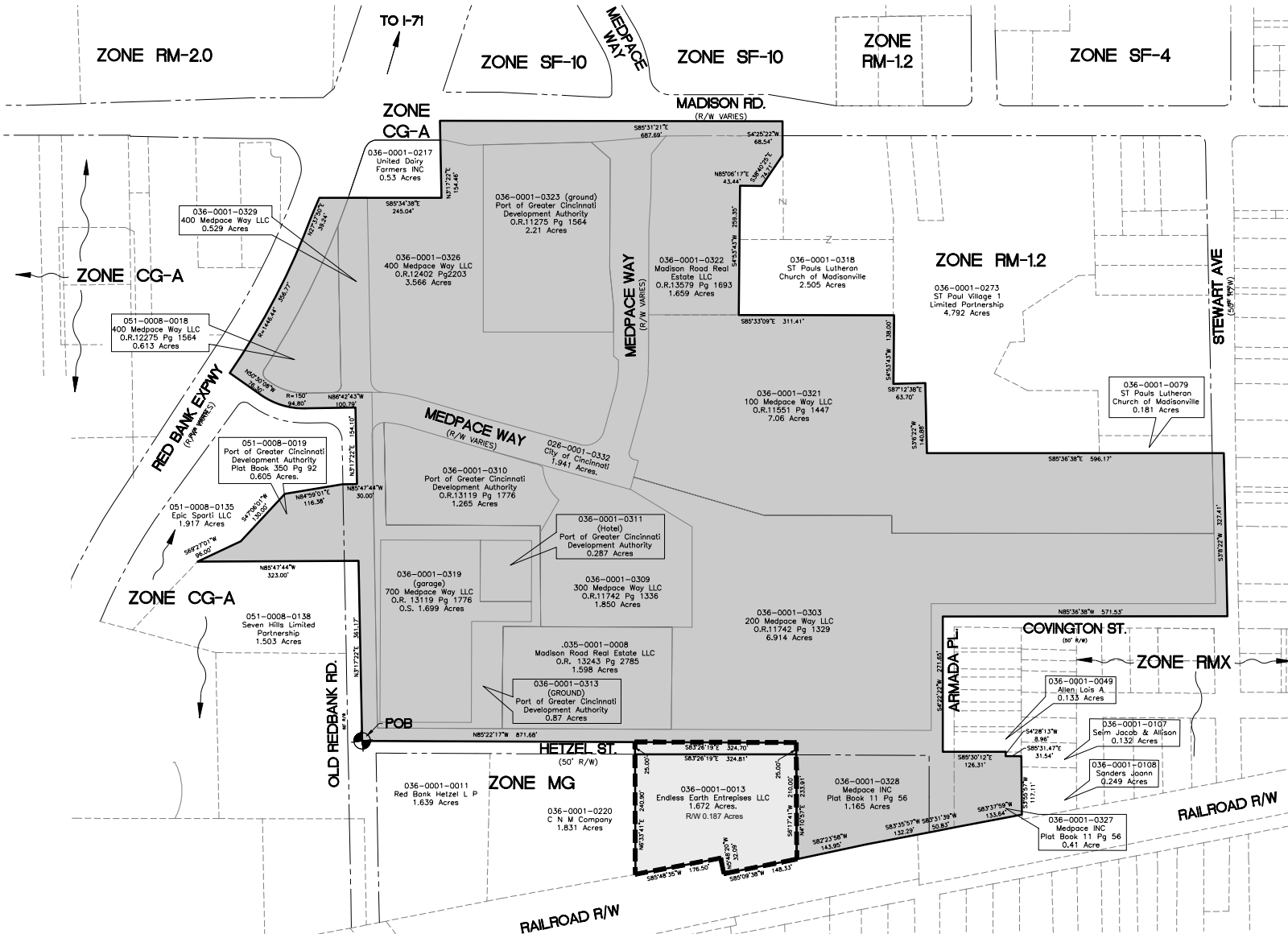

NOTE:
MEDPACE WAY RIGHT OF WAY PARCEL REFLECTS
TO ROAD IMPROVEMENTS COMPLETED IN 2020.

